

A typical Two Bed Apartment Floorplan

TWO BEDROOM APARTMENT:
(66.3m²) no. 059.

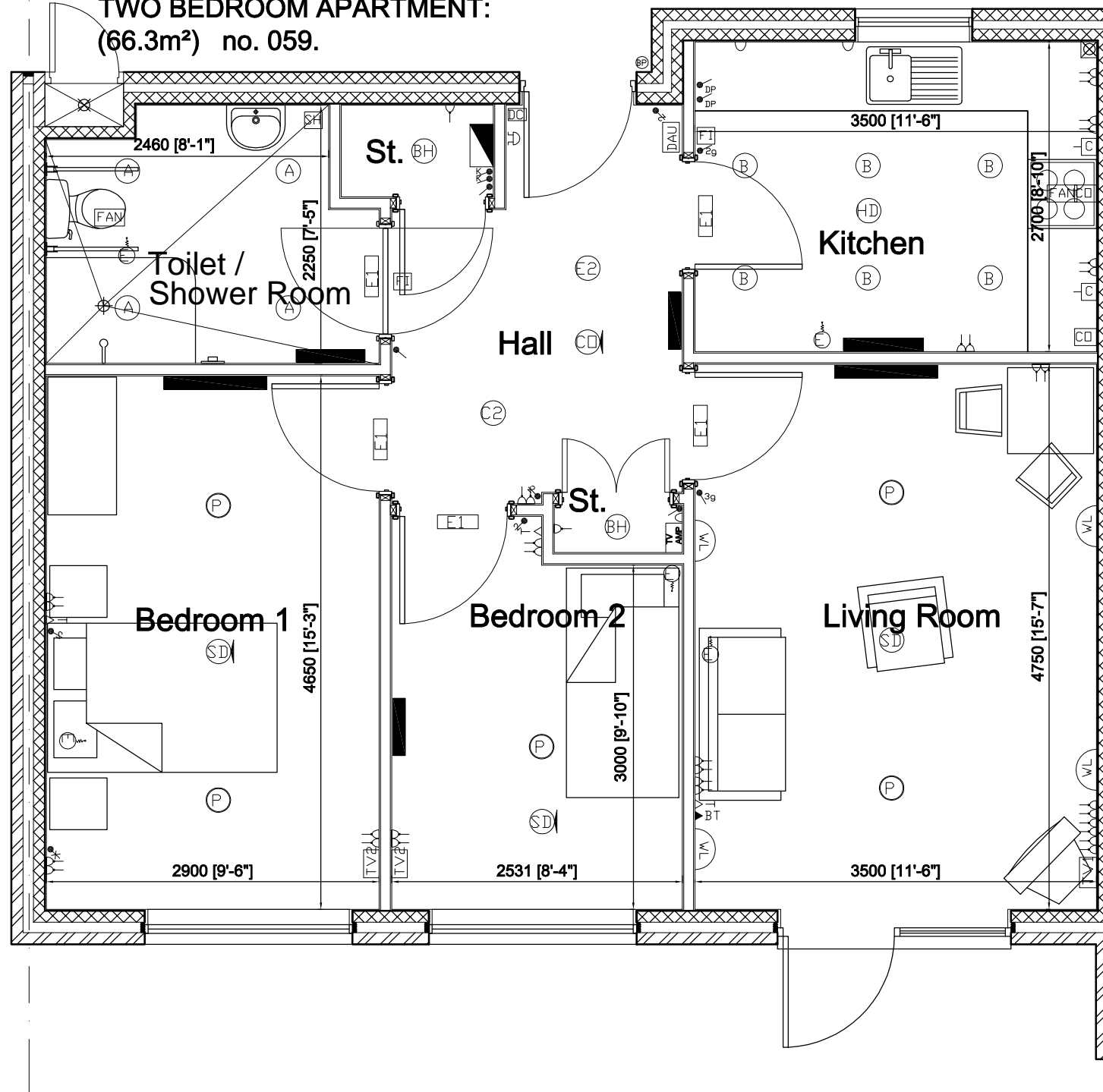

- LST (LOW SURFACE TEMPERATURE) RADIATOR

- CEILING LIGHT
- CEILING LIGHT
- HALL LIGHT
- HALL LIGHT WITH INTEGRAL EMERGENCY LIGHTING
- CEILING LIGHT BULB HOLDER
- LOW ENERGY LIGHT FITTING
- WALL LIGHT

- SINGLE LIGHT SWITCH
- 2-WAY LIGHT SWITCH
- MULTIGANG SWITCH (No. SHOWN)
- SINGLE SWITCHED SOCKET (WITH NEON INDICATOR)
- TWIN SWITCHED SOCKET (WITH NEON INDICATOR)
- SHAVER SOCKET
- POWER SWITCH WITH NEON INDICATOR
- UNSWITCHED SOCKET
- COOKER SWITCH (WITH NEON INDICATOR)
- COOKER CABLE OUTLET

- BT TELEPHONE SOCKET
- SECONDARY TELEPHONE SOCKET
- DOUBLE GANG SAT/TV/TEL/RADIO SOCKET
- TV SOCKET
- TV AMPLIFIER

- FUSE BOARD WITH CIRCUIT BREAKERS
- FIRE DOOR CLOSER CONNECTION POINT
- BELL PUSH
- DOOR BELL

- EMERGENCY PULL-CORD
- EMERGENCY WALL MOUNTED LIGHT
- WARDEN CALL UNIT WITH SPEAKER AND PULL CORD
- EMERGENCY LIGHTING KEY SWITCH

- SMOKE DETECTOR
- HEAT DETECTOR
- CARBON MONOXIDE DETECTOR WITH SOUNDER ALARM
- SMOKE DETECTOR WITH SOUNDER ALARM
- EXTRACTOR FAN
- FAN ISOLATOR SWITCH

KEY TO DIMENSIONS

Metric Dimension (Millimeters) Imperial Dimension (Feet and Inches)

ALL DIMENSIONS ARE SUBJECT TO CONSTRUCTION TOLERANCES

The particulars are set out as a general outline for guidance only.

The information in this leaflet does not in any way form part of a contract or warranty.